

G.5 Mounting Dimensional Description -- ASA37

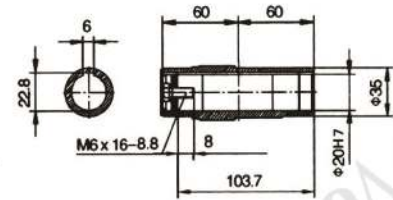
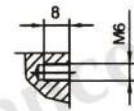
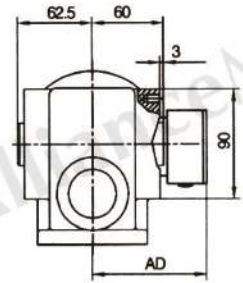
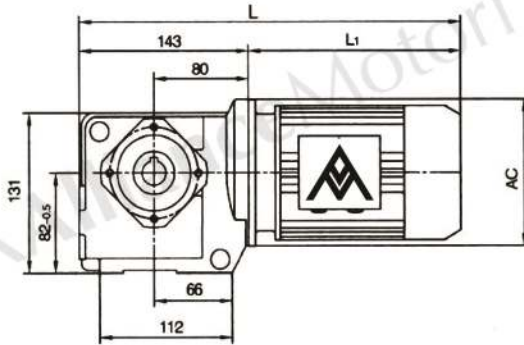

Motor frame size	63	71	80	90S	90L				
AC	130	145	175	195	195				
AD	70	80	145	155	155				
L1	207	225	255	270	295				
L	350	368	398	413	438				

Note : When equipping the user's motor or the special one, the flange is required to connected

G.6 Mounting Dimensional Description -- ASA47-97

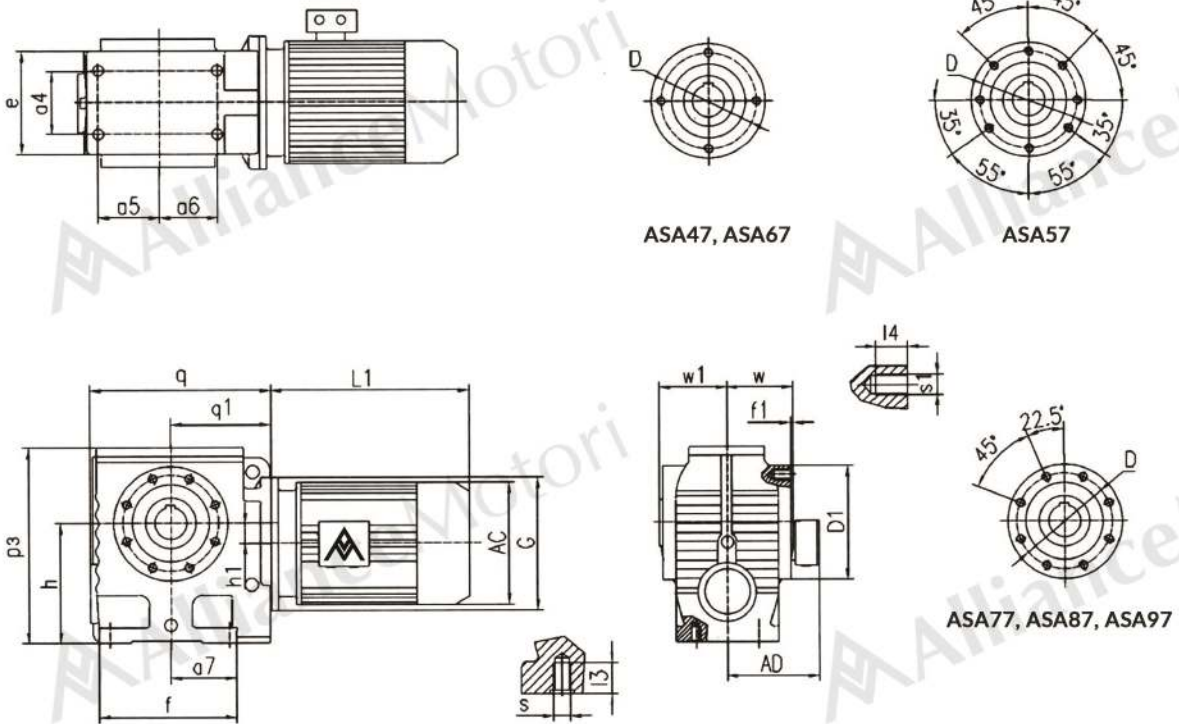

(The bigger diameter of bore)

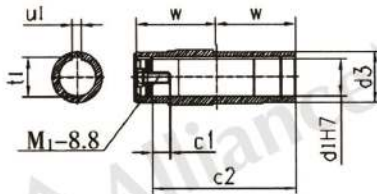

(The smaller diameter of bore)

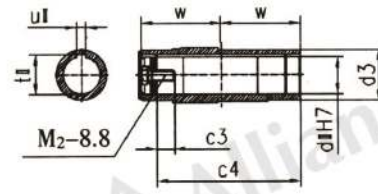

Specification	e h ₁	a ₄ a ₇	a ₅ f	a ₆ w	s f ₁	l ₃ D ₁	s ₁ d ₃	l ₄ d ₁	D U _I	q t ₁	q ₁ d ₁₁	p ₃ u ₁₁	h t ₁₁	c ₁ c ₂	c ₃ c ₄	M ₁ M ₂	G W ₁	Motor Size			
																		AC	AD	L1	
ASA47	94 8	60 67	35 127	52 60	M10 2.5	20 Φ 130	M8 Φ 45	12 Φ 30	Φ 115 8	171 33.3	96 Φ 25	179 8	100 ^{-0.5} 28.3	17 103.7	17 103.7	M10x25 M10x25	Φ 120 63	Please see appendix A-2			
ASA57	100 20	60 73	58.5 146	58.5 75	M10 3	20 Φ 120	M8 Φ 50	12 Φ 35	Φ 102 10	187 38.3	107 Φ 30	189 8	112 ^{-0.5} 33.3	22 132	17 132	M12x30 M10x25	Φ 120 78				
ASA67	128 22	88 95.5	71.5 182	80.5 84	M12 3.5	25 Φ 155	M12 Φ 65	20 Φ 45	Φ 130 14	242 48.8	135 Φ 40	236 12	140 ^{-0.5} 43.3	29 144	29 144	M16x40 M16x40	Φ 160 87				
ASA87	156 34	102 104	85 204	85 105	M16 4	32 Φ 178	M12 Φ 80	20 Φ 60	Φ 155 18	287 64.4	162 Φ 50	301 14	180 ^{-0.5} 53.8	37 183	32 183	M20x50 M16x45	Φ 200 108				
ASA97	194 37.5	118 125	115 260	110 125	M16 5	32 Φ 215	M16 Φ 95	26 Φ 70	Φ 180 20	340 74.9	190 Φ 60	368 18	225 ^{-0.5} 64.4	34 220	36 220	M20x50 M20x50	Φ 250 128				
ASA97	236 52	160 140	135 301	113 145	M20 5	36 Φ 260	M16 Φ 120	26 Φ 90	Φ 220 25	420 95.4	240 Φ 70	455 20	280 ⁻¹ 74.9	41 260	34 260	M24x60 M20x50	Φ 300 149				

Note : When equipping the user's motor or the special one, the flange is required to be connected

G.8 Mounting Dimensional Description -- ASA100 / ASAF100

ASA100

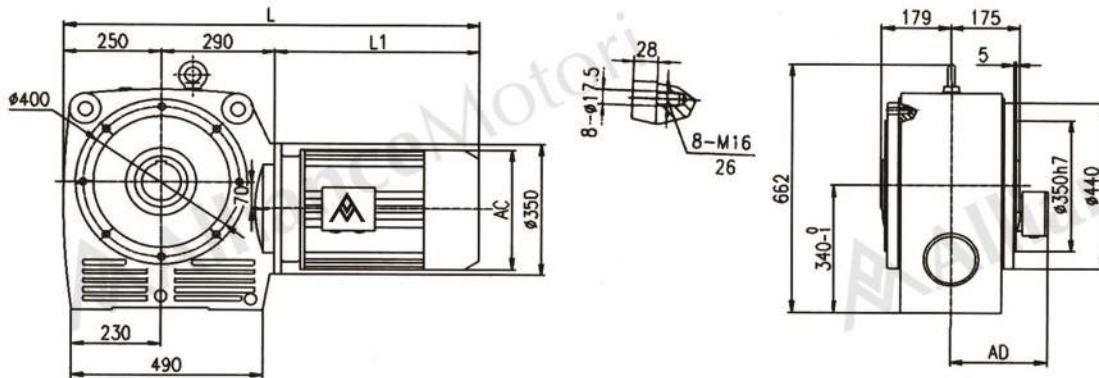

ASAF100

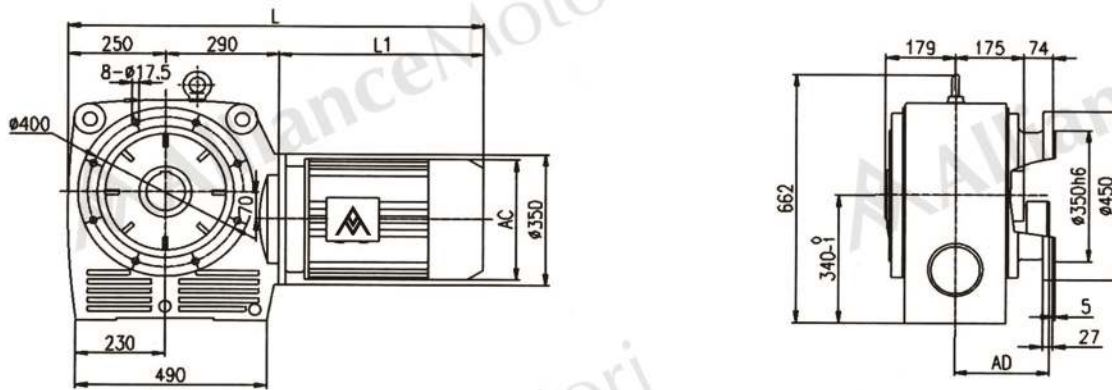

(The bigger diameter of bore)

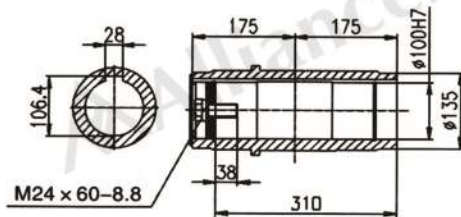

(The smaller diameter of bore)

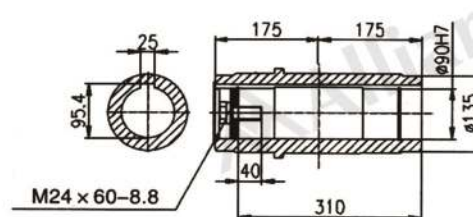

Motor frame size	100L	112M	132S	132M	160M	160L	180M	180L	200L
AC	215	240	275	275	330	330	380	380	420
AD	180	190	210	210	255	255	280	280	305
L1	325	340	390	430	505	560	590	630	660
L	865	880	930	970	1045	1100	1130	1170	1200

Note : When equipping the user's motor or the special one, the flange is required to connected