

H.02 Mounting Dimensional Description - AR-AM (Standard) - AY2 Series

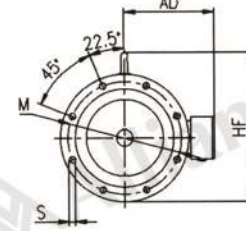
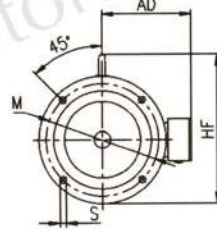
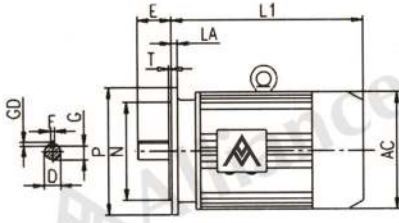

63-200

225-280

Dimensions of Y2 Series Motors

Frame size	Mounting Dimensions																		
	D		E		FxGD		G		M	N	P	S	T	AC	AD	LA	HF	L1	
	2P	4-10P	2P	4-10P	2P	4-10P	2P	4-10P										2P	4-10P
63M	11		23		4X4		8.5		115	95	140	10	3	130	70	10	130	207	
71M	14		30		5X5		11		130	110	160			3.5	145	80	10	145	225
80M	19		40		6X6		15.5		165	130	200	12	195		145	12	185	255	
90S	24	50	8X7	20		215	180	250						15	4	215	180	245	195
90L									195	155	12	195	295						
100L	28	60		24	215	180	250	15	4	215	180	245	325						
112M	38	80	10X8	33	265	230	300	19	5	240	190	265	275	210	14	315	430		
132S													275	210	14	315	430		
132M	38	80	10X8	33	265	230	300	19	5	275	210	14	315	430					
160M	42	110	12X8	37	300	250	350	19	5	330	255	16	385	330	255	16	385	505	
160L														330	255	16	385	560	
180M	48	110	14X9	42.5	380	280	18	430	19	380	280	18	430	380	280	18	430	590	
180L														380	280	18	430	630	
200L	55		16X10	49	350	300	400	19	5	420	305	18	480	660					
225S		60		140	16X10	18X11	53	400	350	450	470	335	20	535	710	705	675	770	
225M	55	60	110	140															49
250M	60	65	140	18X11	53	58	500	450	550	510	370	22	595	845	1020	1100			
280S	65	75															18X11	20X12	58
280M			65	75	18X11	20X12	58	67.5	500	450	550	510	370	22	595	845			
315S	65	80	140	170	18X11	22X14	58	71	600	550	660	24	6	645	530	25	845	1050	1130
315M																			
315L ₁	65	80	140	170	18X11	22X14	58	71	600	550	660	24	6	645	530	25	845	1020	1100
315L ₂																			

H.03 Mounting Dimensional Description - AR-AM (Standard)

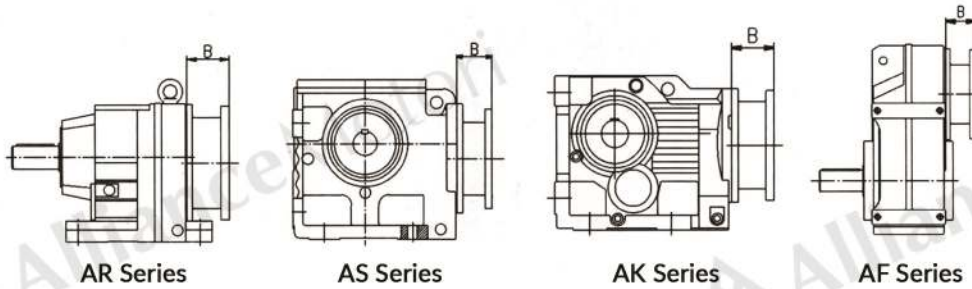

The dimension B of the flange for Y or Y2 series motors

AR Series

	63	71	80	90	100	112	132	160	180	200	225	250	280	315
AR .. 17/27/37	45	50.5	60.5	60.5	85.5									
AR .. 47/57/67	44.5	50	69	69	81	81	93							
AR .. 77 / ARX .. 77	44.5	50	70	70	75	75	96.5	125						
AR .. 87 / ARX .. 87			70	70	82	82	92	130	130					
AR .. 97 / ARX .. 97			65	65	81.5	81.5	92	125	125	152				
AR .. 107 / ARX .. 107					68	68	106	126	126	140	170			
AR .. 137 / ARX .. 137							106	127	127	140	170	192.5	192.5	
AR .. 147								120	120	139	169	192.5	192.5	
AR .. 167/177								115	115	160	170	192.5	192.5	260
ARX .. 57/67	44.5	50	69	69	81	81	93							

AS Series

	63	71	80	90	100	112	132	160	180	200				
AS .. 37/47/57	45	50.5	60.5	60.5	85.5									
AS .. 67	44.5	50	69	69	81	81	93							
AS .. 77	44.5	50	70	70	75	75	96.5	125						
AS .. 87			70	70	82	82	92	130	130					
AS .. 97			65	65	81.5	81.5	92	125	125					
AS .. 100					68	68	106	126	126	140				

AK Series

	63	71	80	90	100	112	132	160	180	200	225	250	280	315
AK .. 37	45	50.5	60.5	60.5	85.5									
AK .. 47/57/67	44.5	50	69	69	81	81	93							
AK .. 77	44.5	50	70	70	75	75	96.5	125						
AK .. 87			70	70	82	82	92	130	130					
AK .. 97				65	81.5	81.5	92	125	125	152				
AK .. 107					68	68	106	126	126	140	170			
AK .. 127							98.5	120	120	139	169	192.5	192.5	
AK .. 157/167/187								115	115	160	170	192.5	192.5	260

AF Series

	63	71	80	90	100	112	132	160	180	200	225	250	280	315
AF .. 37/47	45	50.5	60.5	60.5	85.5									
AF .. 57/67	44.5	50	69	69	81	81	93							
AF .. 77	44.5	50	70	70	75	75	96.5	125						
AF .. 87			70	70	82	82	92	130	130					
AF .. 97				65	81.5	81.5	92	125	125	152				
AF .. 107					68	68	106	126	126	140	170			
AF .. 127							98.5	120	120	139	169	192.5	192.5	
AF .. 157								115	115	160	170	192.5	192.5	260